

Venue: Seijo University (6-1-20 Seijo, Setagaya-ku, Tokyo 157-8511)

It takes about fifteen minutes on the Odakyu Line express or semi-express from Shinjuku Station to

Seijo Gakuenmae Station. Seijo University is a **five-minute walk** from the station.

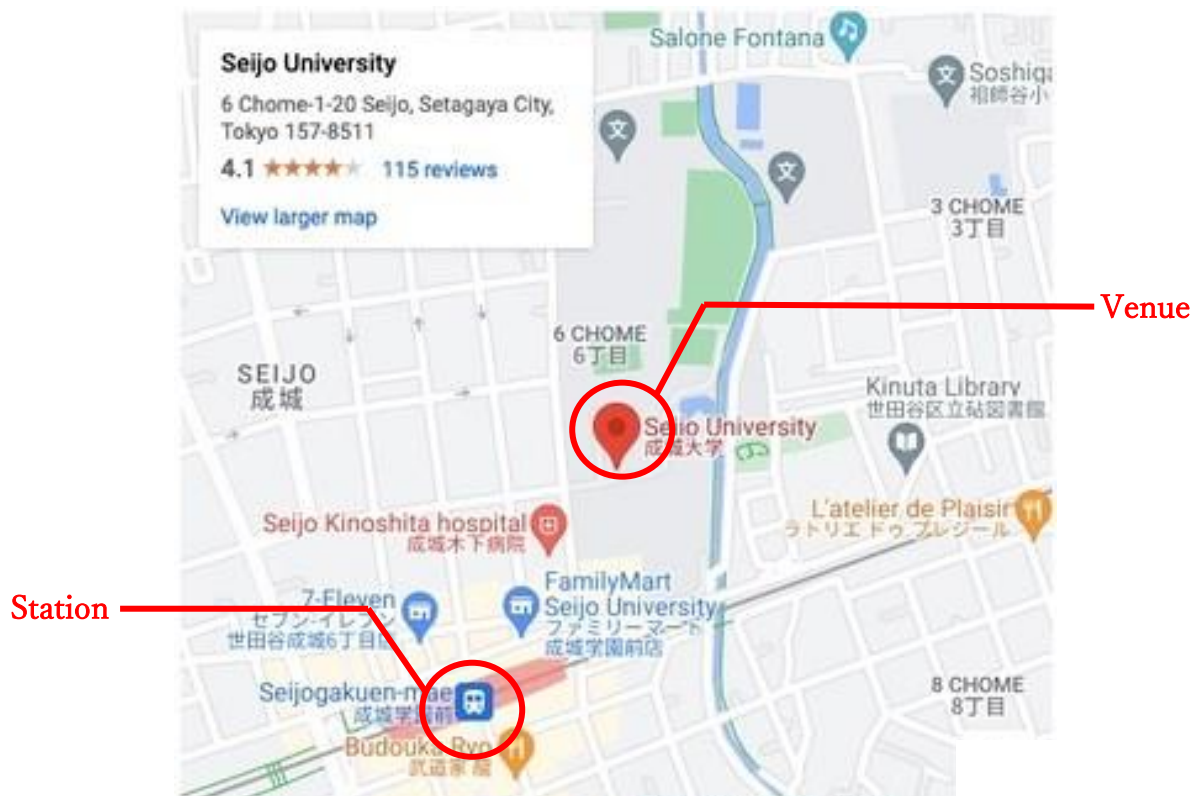
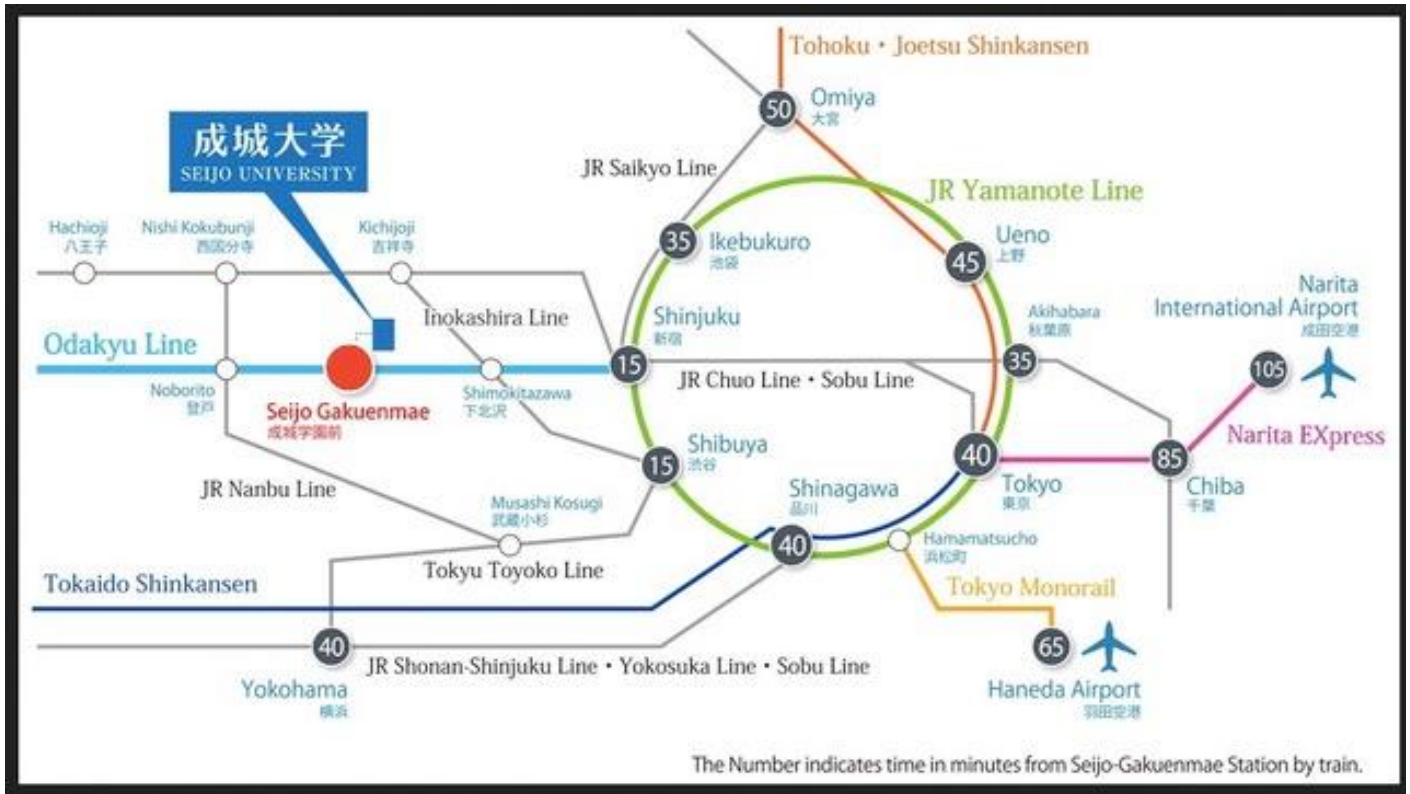

Campus Map

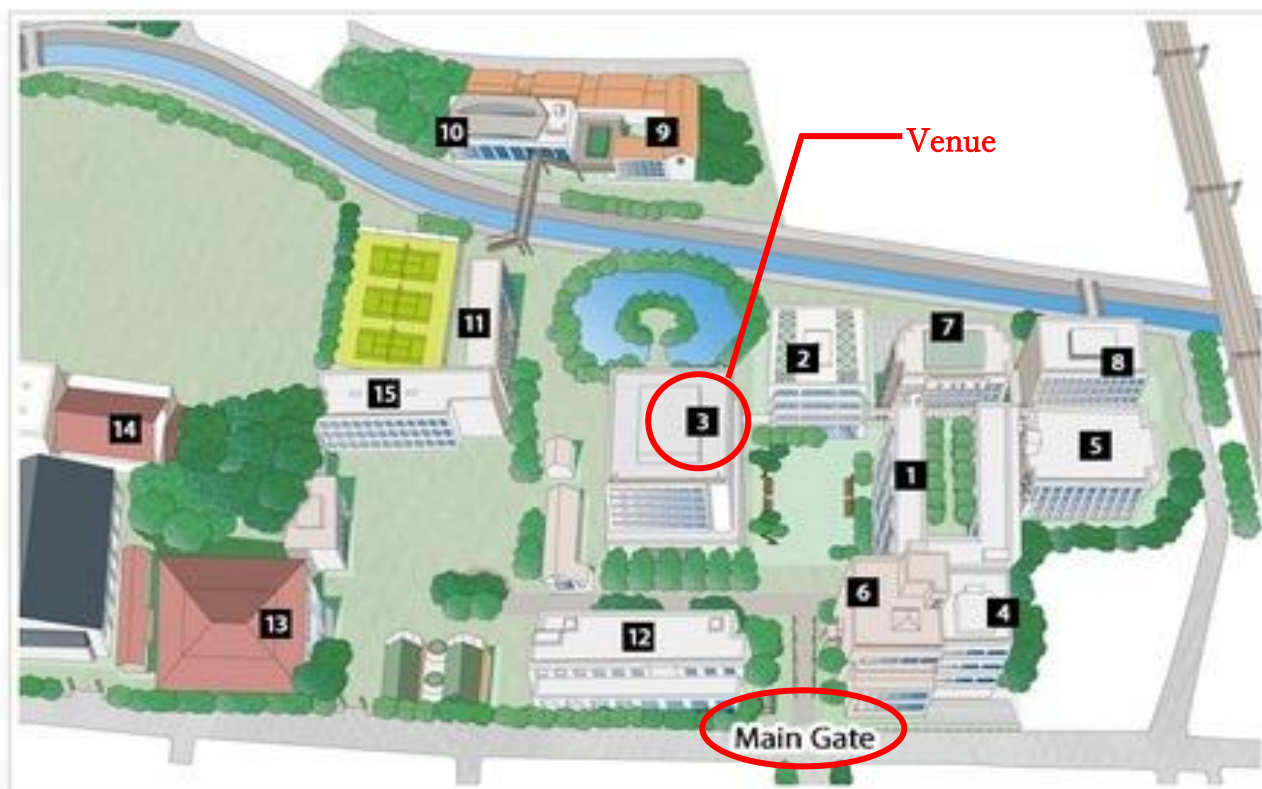

1st Floor

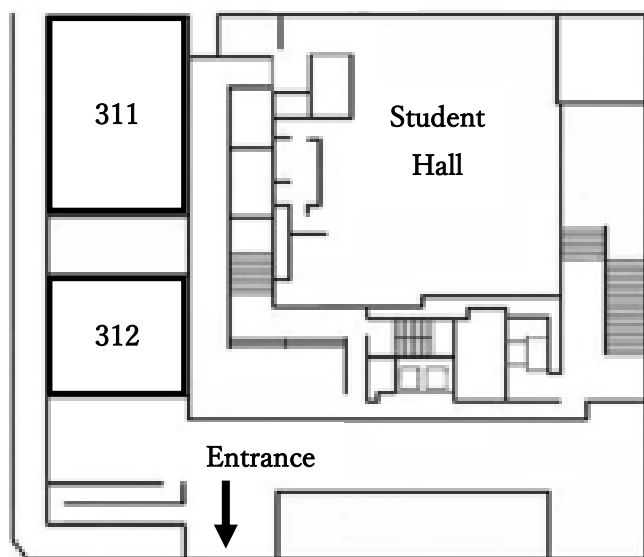

2nd Floor

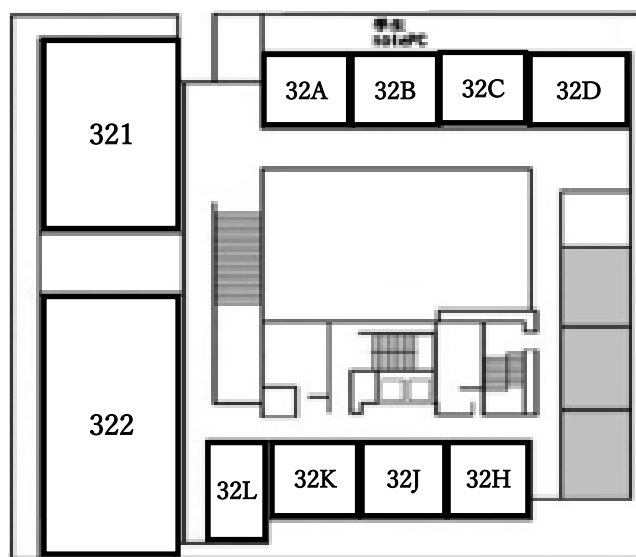

1st Floor

- Entrance:** Registration
- Room 311:** session 7, 9
- Student Hall:** Poster Presentation
Reception Party

2nd Floor

- Room 321:** Session 2, 4, 6
- Room 322:** Opening Ceremony
Guest Lectures
Session 1, 3, 5, 8
- Room 32 A- D:** Book Exhibition
- Room 32 H:** Presenters' Room
- Room J-K:** General Lounge