

ELSJ 17th International Spring Forum 2024

May 25-26, 2024

Faculty of Letters Main Building, Kyoto University, Kyoto*

Saturday, May 25

12:45 PM	Registration [2F Lobby] (ELSJ members: 2,000 yen, Non-members: 5,000 yen, Non-member students: 3,000 yen)	
1:15 PM-1:30 PM	Opening Ceremony [Lecture Room 3]	
1:30 PM-2:15 PM	Guest Lecture 1 [Lecture Room 3] (Chair: Daisuke Nonaka, Kogakuin University)	
	Yuki-Shige Tamura (Osaka University) <i>Toward a Fuller Symbolic View of Grammar: The Theoretical Orientation of Cognitive Phonology and Its Application to Japanese Prosody</i>	
	Lecture Room 6	Lecture Room 7
2:25 PM-2:55 PM	Session 1 (Chair: Hironobu Kasai, Aoyama Gakuin University)	Session 2 (Chair: Masaki Yasuhara, Ibaraki University)
	Gen Kasai (Osaka University) <i>Notes on Adjectival Predicate Ellipsis and Its Theoretical Implication for Argument Ellipsis</i>	Takashi Ishida (Hiroshima Shudo University) and Ryohei Naya (University of Tsukuba) <i>Nominalising Suffixed Adjectives via Lexicalisation and Clipping</i>
3:00 PM-3:30 PM	Yuka Usui (Kyushu University) <i>A Phase-based Analysis of Subject-Object Asymmetry in Nonfinite Clauses</i>	Keigo Ujiie (National Institute for Japanese Language and Linguistics) <i>The Reciprocal Uses of Relational Nouns in Japanese and English: Conceptual Symmetry and Its Linguistic Manifestations</i>
3:40 PM-4:10 PM	Session 3 (Chair: Mina Sugimura, Ritsumeikan University)	Session 4 (Chair: Naoko Komoto, National Institute of Technology, Ishikawa College)
	Hiromune Oda (The University of Tokyo) <i>P as a Locus of Definiteness in the Extended Projections of the Nominal Domain</i>	Linmin Zhang (NYU Shanghai) <i>Analyzing English "Only" as "Not Any More/Other Than"</i>
4:15 PM-4:45 PM	Airi Chikamori (Tohoku University) <i>The Movement Analysis for Temporal Interpretations in Relative Clauses</i>	Zicheng Xu (Kobe University) <i>Update Semantics with Accessibility Relation</i>
4:55 PM-5:40 PM	Guest Lecture 2 [Lecture Room 3] (Chair: Chigusa Morita, Teikyo University Junior College)	
	Akiko Nagano (University of Shizuoka) <i>The English Verbal Prefix out- and the Relationship Between Its Spatial and Differential Types</i>	
6:00 PM-7:00 PM	Conference Reception [Lecture Room 1]	

*Information on the floors and rooms will be announced later.
 For the latest update, see http://elsj.jp/sf_top/



Sunday, May 26

	Lecture Room 6	Lecture Room 7	Lecture Room 3
	Session 5 (Chair: Satoru Kanno, Tokyo University of Science)	Session 6 (Chair: Suguru Mikami, Daito Bunka University)	
9:30 AM-10:00 AM	Ryoichiro Kobayashi (Tokyo University of Agriculture) <i>Phi-Agreement and the Raising-to-Object Constructions in English and Japanese</i>	Mai Kubota (Yamaguchi University / Kyushu University) <i>Two Types of Additional Wh-Effects and Wh-Construals</i>	
10:05 AM-10:35 AM	Chunmei Borjigin and Chigchi Bai (Inner Mongolia University of Finance and Economics) <i>The Reflexive-Possessive Rule in Mongolian as Binding Principle A and Its Implications on English</i>	Yuki Tanaka (The University of Tokyo) <i>Contextually Determined Last Resorts: A View from English Do-Support and French C'est-Cleft</i>	
	Session 7 (Chair: Akira Machida, Nihon University)	Session 8 (Chair: Fumino Horiuchi, Japan Women's University)	Session 9 (Chair: Gakuji Kumagai, Kansai University)
10:45 AM-11:15 AM	Hiroyuki Iwasaki (Utsunomiya University) <i>A Search-Based Treatment of Adjuncts</i>	Annina Heini, Krzysztof Kredens and Lucia Busso (Aston University) <i>Idiolectal Google Search Patterns as Forensic Linguistic Evidence</i>	Young-Kook Kwon (Dongduk Women's University) and Jong-Bok Kim (Kyung Hee University) (Guest Speakers from the English Linguistic Society of Korea) <i>Understanding English let alone Construction: A Corpus-Based Approach</i>
11:20 AM-11:50 AM	Hsiao-Hung Iris Wu (National Taiwan Normal University) <i>The Syntax of Clausal Arguments from a Comparative Perspective</i>	Lieke Verheijen (Radboud University) <i>Accommodation in English Computer-Mediated Communication: Do Age and First Language Affect Alignment with Textisms and Emoji?</i>	Akira Watanabe (The University of Tokyo) <i>Question-Response Pairs with Subjective Predicates</i>
12:00 PM-12:30 PM	Riichi Yoshimura (Kyushu University) <i>A Syntactic Investigation of Conditional Conjunctions</i>	Chigchi Bai (Inner Mongolia University of Finance and Economics) <i>Passivization by Voice: A Merge-Based Approach</i>	Akitaka Yamada (Osaka University) <i>Semantics of Reduplication</i>
1:30 PM-2:50 PM	Poster Session [Lecture Room 2]		
3:00 PM-3:45 PM	Guest Lecture 3 [Lecture Room 3] (Chair: Hiroyuki Nawata, Shimane University)		
	Yuki Hirose (The University of Tokyo) <i>Subject and Object Gaps in Young Learners' L2 English</i>		

Posters (in alphabetical order)

- 1 Atsushi Fujimori (University of Shizuoka), Mineharu Nakayama (The Ohio State University) and Noriko Yoshimura (University of Shizuoka)
Two Types of L1 Transfer in Japanese EFL Learners' L2 English
- 2 Jason Ginsburg (Osaka Kyoiku University), Sandiway Fong (University of Arizona), Hiroshi Terada (Osaka Kyoiku University) and Masumi Matsumoto (Osaka Kyoiku University)
Reconciling Serial Verbs with Labeling and Theta Theory
- 3 Sune Gregersen (Kiel University)
'That' as a Causal Conjunction in West Germanic Languages
- 4 Hideki Maki (Gifu University) and Mjesd'Alpa Gür (Kyoto University)
Particles Mé/Ñ'i Indicating Topic/Contrast in Biji
- 5 Makiko Mukai (University of Kochi)
Anti-Labeling Mechanism for CASE in Complex Compounds in Swedish
- 6 Kanta Tateno (Osaka University)
Exploring the Pragmatic Dimensions of 'Any': Insights from Domain Widening
- 7 Chyan-An Arthur Wang (Chung Yuan Christian University)
A Syntactic Analysis of Excessive Serial Verb Construction in Mandarin Chinese

Venue: Kyoto University Yoshida Campus, Faculty of Letters Main Building (8 on the lower map)

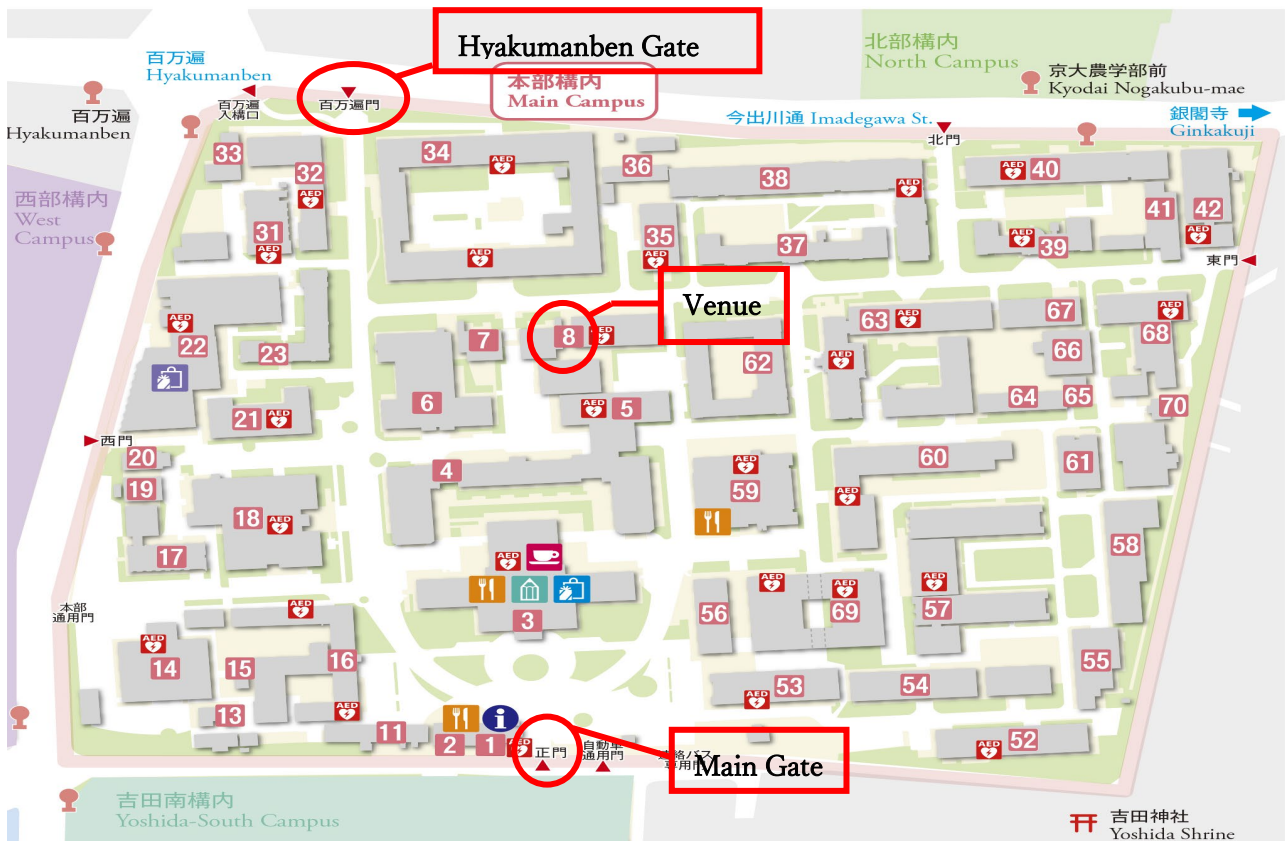
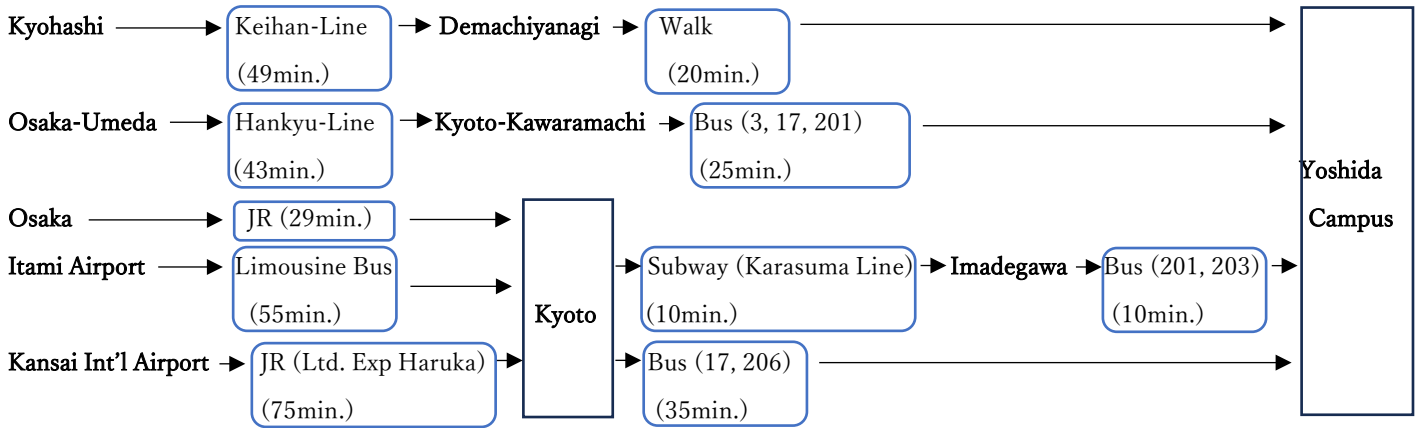

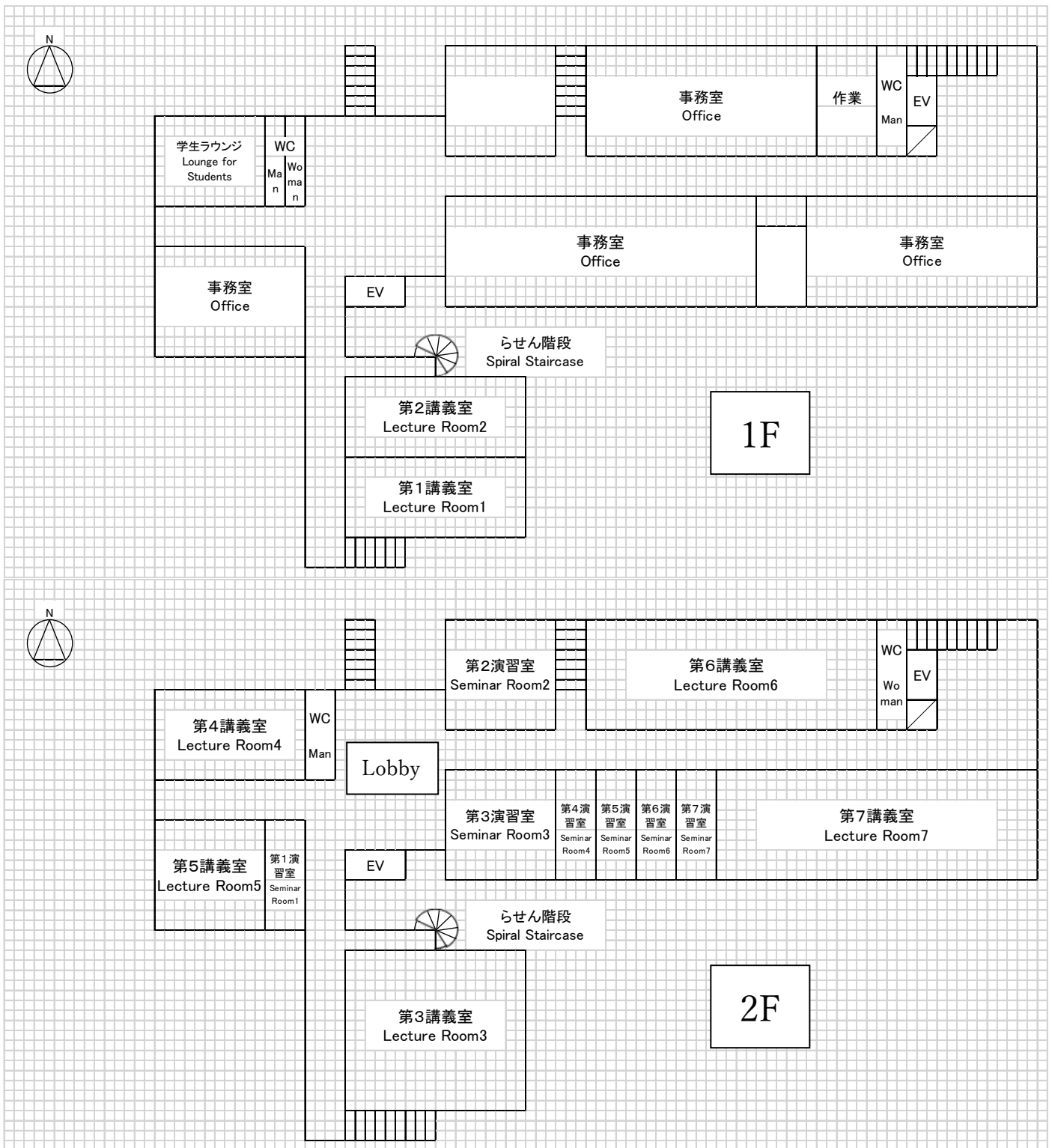

2F Lobby … Registration

Lecture Room 1 … Reception

Lecture Room 2 … Poster Session

Lecture Room 3 … Opening Ceremony, Guest Lecture, Session 9

Lecture Room 4 … Waiting Room for Presenters

Lecture Room 5 … General Waiting Room

Lecture Room 6 … Session 1, 3, 5, 7

Lecture Room 7 … Session 2, 4, 6, 8

Seminar Room 2, 3 … Book Exhibition

You can download different kinds of maps here

